

ICDM Workshops 2007



**Seventh IEEE International Conference on
Data Mining**

Workshop programs

Embassy Suite

Omaha, Nebraska, USA

Sunday, October 28th 2007

ICDM 2007 Workshop Programs

Sunday, October 28th 2007

	Room - Platte	Room - Elkhorn C	Room - Elkhorn B	Room - Missouri	Room - Big Blue A
AM1 8:30 - 10:00	KDMM - Knowledge Discovery from Multimedia Data	PPDM - Privacy Aspects of Data Mining	MMBD - Mining and Management of Biological Data	OptDMA - Optimization-based Data Mining Techniques with Applications	HPDM - High Performance Data Mining
10:00 - 10:30	COFFEE BREAK	COFFEE BREAK	COFFEE BREAK	COFFEE BREAK	COFFEE BREAK
AM2 10:30 - 12:00	KDMM - Knowledge Discovery from Multimedia Data	PPDM - Privacy Aspects of Data Mining	MMBD - Mining and Management of Biological Data	OptDMA - Optimization-based Data Mining Techniques with Applications	HPDM - High Performance Data Mining
12:00 - 1:30	LUNCH	LUNCH	LUNCH	LUNCH	LUNCH
PM1 1:30 - 3:30	Tutorial	Web2DM - Data Mining in Web 2.0 Environments		OptDMA - Optimization-based Data Mining Techniques with Applications	HPDM - High Performance Data Mining
3:30 - 4:00	COFFEE BREAK	COFFEE BREAK	COFFEE BREAK	COFFEE BREAK	COFFEE BREAK
PM2 4:00 - 6:00	Tutorial	Web2DM - Data Mining in Web 2.0 Environments		OptDMA - Optimization-based Data Mining Techniques with Applications	

	Room - Big Blue B	Room - Elkhorn A	Room - Big Blue C	Room - Council Bluffs A	Room - Council Bluffs B
AM1 8:30 - 10:00	MGCS (MiGs) - Mining Graphs and Complex Structures	SSTDM - Spatial and Spatio-Temporal Data Mining	DUNE(DMU) - Data Mining on Uncertain Data	DMMed - Data mining in Medicine	Dstream - Data Streaming Mining and Management
10:00 - 10:30	COFFEE BREAK	COFFEE BREAK	COFFEE BREAK	COFFEE BREAK	COFFEE BREAK
AM2 10:30 - 12:00	MGCS (MiGs) - Mining Graphs and Complex Structures	SSTDM - Spatial and Spatio-Temporal Data Mining	DUNE(DMU) - Data Mining on Uncertain Data	DMMed - Data mining in Medicine	Dstream - Data Streaming Mining and Management
12:00 - 1:30	LUNCH	LUNCH	LUNCH	LUNCH	LUNCH
PM1 1:30 - 3:30	MGCS (MiGs) - Mining Graphs and Complex Structures	SSTDM - Spatial and Spatio-Temporal Data Mining	DUNE(DMU) - Data Mining on Uncertain Data		
3:30 - 4:00	COFFEE BREAK	COFFEE BREAK	COFFEE BREAK	COFFEE BREAK	COFFEE BREAK
PM2 4:00 - 6:00		SSTDM - Spatial and Spatio-Temporal Data Mining			

EMBASSY SUITES HOTEL OMAHA DOWNTOWN/OLD MARKET - FIRST FLOOR

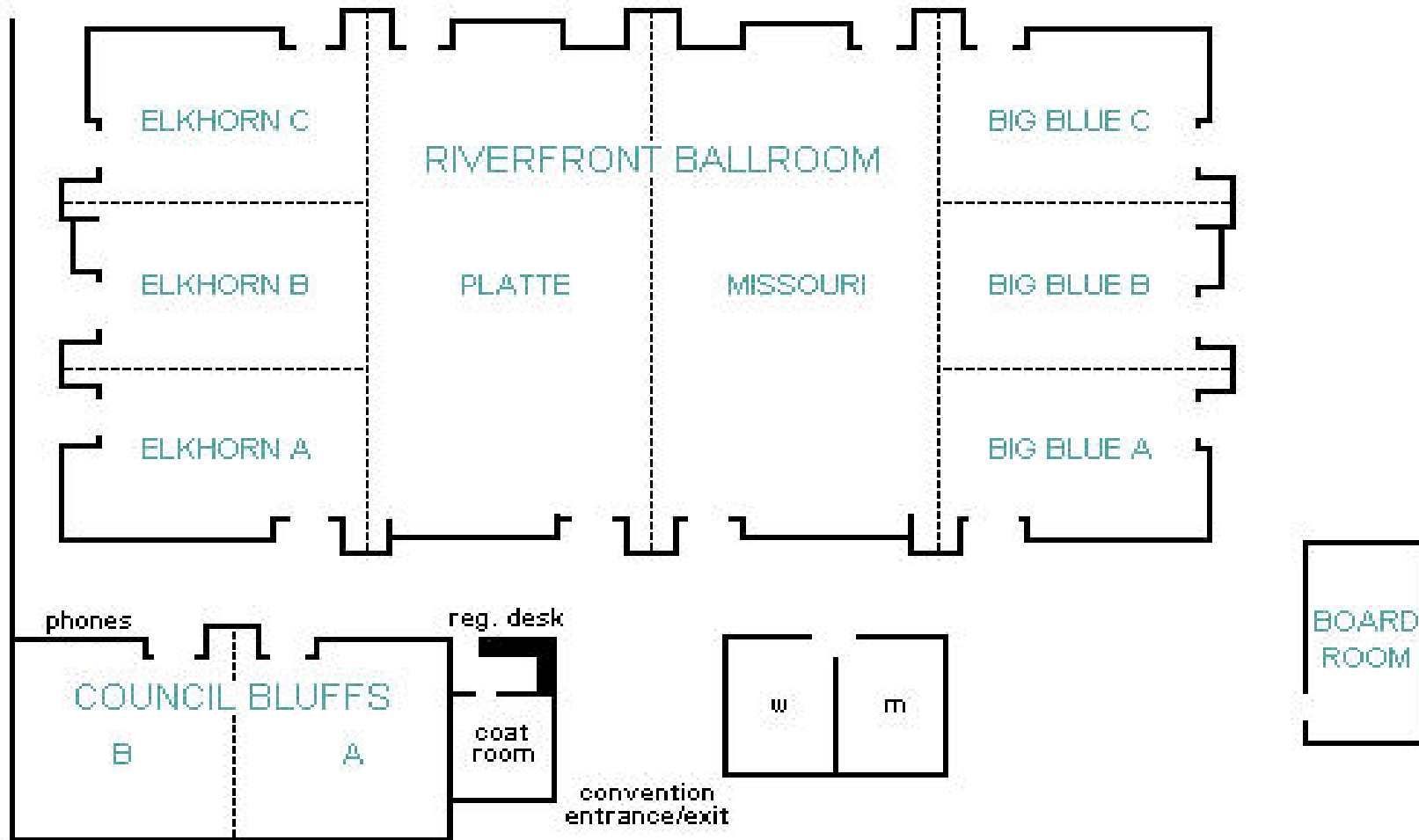

ICDM 2007 Workshop Programs

ICDM 2007 Workshop Program Chairs:

Anthony K.H. Tung, National University of Singapore (Singapore)

Qiuming Zhu, University of Nebraska at Omaha (USA)

Workshops and Workshop Chairs

Web2DM - Data Mining in Web 2.0 Environments	4
Co-chairs: Andreas Hotho, Michael Wurst and Ravi Kumar	
KDMM - Knowledge Discovery from Multimedia Data and Multimedia Applications.....	5
Co-chairs: Xingquan Zhu, Dacheng Tao & Walid G. Aref	
MMBD - Mining and Management of Biological Data.....	6
Co-chairs: Wei Wang and Luke Huan	
DMMed - Data mining in Medicine.....	7
Co-chairs: Daniela Stan Raicu and Mohammad Siadat	
OptDMA - Optimization-based Data Mining Techniques with Applications.....	8
Chair: Yong Shi	
HPDM - High Performance Data Mining.....	10
Co-chairs: Alok Choudhary, Ying Liu	
MGCS (MiGs) - Mining Graphs and Complex Structures.....	12
Co-chairs: Xifeng Yan, Lawrence B. Holder	
DUNE (DMU) - Data Mining on Uncertain Data.....	14
Co-chairs: Jiong Yang, Reynold Cheng	
Dstream - Data Streaming Mining and Management.....	16
Co-chairs: Wei Fan, Haixun Wang, Philip Yu	
SSTDM - Spatial and Spatio-Temporal Data Mining.....	17
Co-chairs: Chang-Tien Lu, Ashok Samal, Shashi Shekhar	
PPDM - Privacy Aspects of Data Mining.....	19
Co-chairs: Stanley Oliveira, Jaideep Vaidya and Rebecca Wright	
ICDM 2007 Workshop Program Committees and Organizations	20

Web2DM - Data Mining in Web 2.0 Environments

Room:	Elkhorn C
Co-chairs:	Andreas Hotho, Michael Wurst and Ravi Kumar

- 12:00-- **Lunch Break**
- 13:30-- Michael Wurst, Andreas Hotho, Ravi Kumar
Introduction
- 14:00-- Chia-Hui Chang, Fred Tsai
“Aspect Summarization from Blogosphere for Social Study”
- 14:30-- Haizheng Zhang, Wei Li, Xuerui Wang, C. Lee Giles, Henry C. Foley, John Yen
“HSN-PAM: Finding Hierarchical Probabilistic Groups From Large-Scale Networks”
- 15:00-- Vivek Sehgal, Charles Song
“SOPS: Stock Prediction using Web Sentiment”
- 15:30-- **Coffee Break**
- 16:00-- Lyle Ungar
“Information Extraction from Informal Texts” (Invited Talk)
- 17:00-- Sisay Fissaha Adafre, Maarten de Rijke
“Ask the Crowd to Find Out What’s Important”
- 17:30-- Shuyi Zheng, Ding Zhou, Jia Li, Lee Giles
“Extracting Author Meta-Data from Web”
- 18:00-- Chia-Hui Chang, Mohammed Kayed, Khaled Shaalan, Ramzy Girgis
“FiVaTech: Page-level Web Data Extraction from Template Pages”

KDMM - Knowledge Discovery from Multimedia Data and Multimedia Applications

Room:	Platte
Co-chairs:	Xingquan Zhu, Dacheng Tao & Walid G. Aref

8:00--	Registration
8:30--	Liang Wang, Christopher Leckie, Xiaozhe Wang, Jim Bezdek, and Ramamohanarao Kotagiri “Tensor Space Learning for Analyzing Activity Patterns from Video Sequences”
9:00--	Jun Yang, Rong Yan, and Alexander Hauptmann “Adapting SVM Classifiers to Data with Shifted Distributions “
9:30--	Kimiaki Shirahama and Kuniaki Uehara “Video Data Mining: Discovering Topics by Burst Detection in Video Streams”
10:00--	Coffee Break
10:30--	Suzanne Little, Ovidio Salvetti, and Petra Perner “Semi-Automatic Semantic Annotation of Images”
11:00--	Guangyan Huang and Jing He “Automatic Generation of Traditional Style Painting by Using Density-Based Color Clustering”
11:30--	Selim Mimaroglu and Dan Simovici “Bit Sequences and Biclustering of Text Documents”
12:00--	Lunch Break

MMBD - Mining and Management of Biological Data

Room:	Elkhorn B
Co-chairs:	Wei Wang and Luke Huan

- 8:00-- **Registration**
- 8:45-- **Welcome**
- 9:00-- Young-Rae Cho, Woochang Hwang, and Aidong Zhang,
"Assessing Reliability of Protein-Protein Interactions by Semantic Data Integration"
- 9:30-- Rezarta Islamaj Dogan, Lise Getoor, W. John Wilbur
"Characterizing RNA secondary-structure features and their effects on splice-site prediction"
- 10:00-- **Coffee Break**
- 10:30-- Claudia Taeubner, Brigitte Mathiak, and Silke Eckstein
"Modeling and Management of Signal Transduction Pathways with Life Sequence Charts"
- 11:00-- **Parthasarathy Srinivasan, Keynote speaker**
- 12:00-- **Lunch Break**
- 13:30-- Joyita Mallik, Ashok Samal, and Scott Gardner
"A Content Based Pattern Analysis System for a Biological Specimen Collection"
- 14:00-- Li Li, Steffen Heber, Qiang Zhang, and Melvin Andersen
"Statistical Approaches to Identifying Androgen Response Elements"
- 14:30-- Brigitte Mathiak, Andreas Kupfer, Carolina Rio Bartulos, Tatjana Scope, Johann Weiland, and Silke Eckstein
"Discovering gene expression data from the tables of full text publications"
- 15:00-- Hongfang Liu and Manabu Torii
"Names in Biomedical Databases and Names in Free Text"
- 15:30-- **Coffee Break**
- 16:00-- Andrew Arnold, Ramesh Nallapati, and William Cohen
"A Comparative Study of Methods for Transductive Transfer Learning"

DMMED - Data mining in Medicine

Room	Council Bluffs A
Co-chairs:	Daniela Stan Raicu and Mohammad Siadat

- 8:00-- **Registration**
- 8:30-- Mohammad-Reza Siadat, Hamid Soltanian-Zadeh, Farshad Fotouhi, Ameen Eetemadi, Kost Elisevich
"Data Modeling for Content-Based Support Environment (C-BASE): Application on Epilepsy Data Mining"
- 8:48-- Ameen Eetemadi, Mohammad-Reza Siadat, Hamid Soltanian-Zadeh, Farshad Fotouhi, Kost Elisevich
"Content-Based Support Environment (C-BASE): Data Preparation and Similarity Measurement"
- 9:06-- Hidenao Abe, Miho Ohsaki, Hideto Yokoi, Takahira Yamaguchi
"Developing an Integrated Time-Series Data Mining Environment for Medical Data Mining"
- 9:24-- Michele Berlingerio, Francesco Bonchi, Fosca Giannotti, Franco Turini
"Time-annotated Sequences for Medical Data Mining"
- 9:42-- Shoji Hirano, Shusaku Tsumoto
"Identifying Exacerbating Cases in Chronic Diseases Based on the Cluster Analysis of Trajectory Data on Laboratory Examinations"
- 10:00-- **Coffee Break**
- 10:30-- Mark Last, Rafael Carel, Dotan Barak
"Utilization of Data- Mining Techniques for Evaluation of Patterns of Asthma Drugs Use by Ambulatory Patients in a Large Health Maintenance Organization"
- 10:48-- Kimiko Matsuoka, Shigeki Yokoyama, Kunitomo Watanabe, Shusaku Tsumoto
"Analysis of Relationship between Blood Stream Infection and Clinical Background in Patients' Lactobacillus Therapy by Data Mining"
- 11:06-- William Horsthemke, Ekarin Varutbangkul, Daniela Raicu, Jacob Furst
"Predictive Data Mining for Lung Nodule Interpretation"
- 11:24-- Dina Demner-Fushman, Sameer Antani, George Thoma
"Automatically Finding Images for Clinical Decision Support"
- 11:42-- Vikramaditya Jakkula,
"Predictive Data Mining to Learn Health Vitals of Residents in a Smart Home"

OptDMA - Optimization-based Data Mining Techniques with Applications

Room: Missouri

Chair: Yong Shi

8:00-- **Registration**

8:30-- Qiufen Xiong, Jie Gao, Huanzhu Liu, and Mingxuan Shao
"Physical Analysis of Precipitation Factors Based On SVM Method"

8:50-- Yong Shi, Ying-jie Tian, Xiaojun Chen, and Peng Zhang
"A Regularized Multiple Criteria Linear Program for Classification"

9:10-- Peng Zhang, Jingran Dai
"Multiple-Criteria Linear Programming for VIP E-Mail Behavior Analysis"

9:30-- Jing He and Guangyan Huang
"Cluster Analysis and Optimization in Color-based DBSCAN Clustering for Image Abstract"

9:50-- Olvi Mangasarian and Edward Wild
"Feature Selection for Nonlinear Kernel Support Vector Machines"

10:10-- **Coffee Break**

10:40-- Yi Peng, Gang Kou
"Categorical Attribute Transformation Technique for Multiple Criteria Quadratic Programming Classification Model"

11:00-- Chuan Shi, Zhongzhi Shi, and Bin Wu
"An Efficient Fitness Assignment Based on Dominating Tree"

11:20-- William-Chandra Tjhi and Lihui Chen
"Dual Fuzzy-possibilistic Co-clustering and Its Application for Document Categorization and Summarization"

11:40-- Kreshna Gopal and Thomas Ioerger
"Distance Metric Learning through Rank Optimization"

12:00-- **Lunch Break**

13:30-- Nian Yan, Zhenyuan Wang, Zhengxin Chen
"Classification with Choquet Integral with Respect to Signed Non-Additive Measure"

- 13:50-- Adam Anthony and Marie desJardins
"Data Clustering with a Relational Push-Pull Model"
- 14:10-- Yanbo Wang, Qin Xin, and Frans Coenen
"A Novel Rule Weighting Approach in Classification Association Rule Mining"
- 14:30-- Tiny Du Toit and André De Waal
"Generalized Additive Models From A Neural Network Perspective"
- 14:50-- Shuxin Li, Robert Lee, and Sheau-Dong Lang
"Mining Distance-based Outliers from Categorical Data"
- 15:10-- Yasutoshi Yajima and Teppei Sato
"Semi-Supervised Kernel Logistic Regression and its Extension to Active Learning based on A-optimality"
- 15:30-- **Coffee Break**
- 16:00-- Mark Last
"Predicting and Optimizing Classifier Utility with the Power Law"
- 16:20-- Hung-Ching (Justin) Chen, Malik Magdon-Ismael, Mark Goldberg, and William A. Wallace
"Learning What Makes A Society Tick"
- 16:40-- Le Gruenwald, Hamed Chok, and Mazen Aboukhamis
"Using Data Mining to Estimate Missing Sensor Data"
- 17:00-- Ding Zhou, Hongyuan Zha, Jia Li, Huajing Li, Wang-chien Lee, and C. Lee Giles
"Learning to Rank Social Network Actors"
- 17:20-- Frédéric Flouvat, Fabien De Marchi, and Jean-Marc Petit
"Rapid prototyping of pattern mining problems isomorphic to boolean lattices"
- 17:40-- Zhen Guo, Zhongfei Zhang, and Eric Xing
"Semi-supervised Learning Based on Semiparametric Regularization"
- 18:00-- Wei Peng
"A Semi-automatic System with an Iterative Learning Method for Discovering the Leading Indicators in Business Processes"

HPDM - High Performance Data Mining

Room:	Big Blue A
Co-chairs:	Alok Choudhary, Ying Liu

- 8:00-- **Registration**
- 8:30-- Wassim AYADI, Khedija AROUR, and Wassim AYADI
“A Novel Parallel boolean approach for discovering frequent itemsets“
- 9:00-- Xiaonan Ji and James Bailey
“An efficient technique for mining approximately frequent substring patterns“
- 9:30-- Ramesh Nallapati, Amr Ahmed, William Cohen, and Eric Xing
“Sparse Word Graphs: A Scalable Algorithm for Capturing Word Correlations in Topic Models“
- 10:00-- **Coffee Break**
- 10:30-- Ramesh Nallapati, William Cohen, and John Lafferty
“Parallelized Variational EM for Latent Dirichlet Allocation: An Experimental Evaluation of Speed and Scalability“
- 11:00-- Baoying Wang and Imad Raha
“WC-clustering: Hierarchical Clustering using the Weighted Confidence Affinity Measure“
- 11:30-- Lin Zhou, Ying Liu, Jing Wang, and Yong Shi
“Utility-based Web Path Traversal Pattern Mining“
- 12:00-- **Lunch Break**
- 13:30-- Chulmin Yun, Donghyuk Shin, Hyunsung Jo, Jihoon Yang, and Saejoon Kim
“An Empirical Study on Feature Subset Selection Methods“
- 14:00-- Paula Cecilia Fritzsche, Dolores Rexachs, and Emilio Luque
“Extracting Knowledge to Define TSP Asymptotic Time Complexity“
- 14:30-- Gang Chen, Fei Wang, and Changshui Zhang
“Collaborative Filtering Using Orthogonal Nonnegative Matrix Tri-factorization“
- 15:00-- Yi Guo, Junbin Gao, and Paul W Kwan
“Twin Kernel Embedding with Back Constraints“
- 15:30-- **Coffee Break**
- 16:00-- zuobing xu, Ram Akella, Mike Ching, and Renjie Tang

“Semi-supervised Clustering Using Bayesian Regularization“

16:30-- Hiroshi Kuwajima and Takashi Washio

“Large PSD Matrix Estimation from Partial Elements”

17:00-- Kun Zhao, Ying-jie Tian, and Nai-yang Deng

“Robust Unsupervised and Semisupervised Bounded ℓ_1 -Support Vector Machines”

MGCS (MiGs) - Mining Graphs and Complex Structures

Room: Big Blue B

Co-chairs: Xifeng Yan, Lawrence B. Holder

- 9:00-- **Introduction**
- 9:10-- David Jensen, University of Massachusetts Amherst
Keynote Talk: Learning causal dependencies in networks
- 10:00-- **Coffee Break**
- 10:20-- M. Shahriar Hossain and Rafal A. Angryk
"GDClust: A Graph-Based Document Clustering Technique"
- 10:45-- Nurcan Yuruk, Mutlu Mete, Xiaowei Xu, and Thomas Schweiger
"A Divisive Hierarchical Structural Clustering Algorithm for Networks"
- 11:10-- Bin Wu, Xin Pei, and JianBin Tan
"Resume Mining of Communities in Social Network"
- 11:35-- Shouchun Chen, Fei Wang, and Changshui Zhang
"Simultaneous Heterogeneous Data Clustering Based on Higher Order Relationships"
- 12:00-- **Lunch Break**
- 13:30-- Brian Gallagher and Tina Eliassi-Rad,
"An Examination of Experimental Methodology for Classifiers of Relational Data"
- 13:55-- Masoud Makrehchi and Mohamed Kamel,
"Learning Term Dependency Links Using Information Theoretic Inclusion Measure"
- 14:20-- Matthew Rattigan, Marc Maier, and David Jensen,
"Exploiting network structure for active inference in collective classification"
- 14:45-- Mustafa Bilgic, Galileo Mark Namata, and Lise Getoor,
"Combining Collective Classification and Link Prediction"
- 15:10-- **Coffee Break**
- 15:40-- Christophe Costa Florencio,
"Tree Planar Languages"
- 16:05-- William Eberle and Larry Holder,
"Discovering Structural Anomalies in Graph-Based Data"

16:30-- Mathias Fiedler and Christian Borgelt,
"Subgraph Support in a Single Large Graph"

DUNE (DMU) - Data Mining on Uncertain Data

Room:	Big Blue C
Co-chairs:	Jiong Yang, Reynold Cheng

- 8:00-- **Registration**
- 8:30-- **Welcome and Introduction**
- Eirinaios Michelakis, Daisy Zhe Wang, Minos Garofalakis, and Joseph Hellerstein
- 8:35-- **“Granularity Conscious Modeling for Probabilistic Databases”**
- 9:05-- Representing Tuple and Attribute Uncertainty in Probabilistic Databases
Prithviraj Sen, Amol Deshpande, and Lise Getoor
- Jian Xu, Pedrito Maynard-Zhang, and Jianhua Chen
- 9:35-- **“Incremental Integration of Probability Models Learned from Data”**
- 10:05-- **Coffee Break**
- Dirk Habich, Peter-Benjamin Volk, Wolfgang Lehner, Ralf Dittmann, and Clemens Utzny
- 10:30-- **“Error-Aware Density-Based Clustering of Imprecise Measurement Values”**
- Sau Dan Lee, Ben Kao, and Reynold Cheng
- 11:00-- **“Reducing UK-means to K-means”**
- Carson K. Leung
- 11:30-- **“Efficient Mining of Frequent Patterns from Uncertain Data”**
- 12:00-- **Lunch Break**
- 13:30-- Ambuj Singh (University of California at Santa Barbara)
Keynote Speech: Uncertainty in bioimage databases: querying and mining challenges
- 14:20-- Lance Besaw and Donna Rizzo
“An Alternative Method for Performing Conditional Simulation Using a Counterpropagation Network”
- 14:50-- Robert Gwadera, Janne Toivola, and Jaakko Holmen
“Segmenting multi-attribute sequences using dynamic Bayesian networks”
- 15:20-- **Coffee Break**
- 16:00-- Feng Liu and Qiliang Zhu
“A Novel Ordering-based Greedy Bayesian Network Learning Algorithm on Limited Data”

- 16:30-- Erika Vilches Gonzalez, Ivan Alejandro Escobar Broitman, Edgar E. Vallejo, and Charles E. Taylor
“Targeting Input Data for Acoustic Bird Species Recognition Using Data Mining and HMMs”
- 17:00-- Chaker Jebari and Habib Ounelli
“Genre categorization of web pages”
- 17:30-- Jason Van Hulse, Taghi Khoshgoftaar, and Amri Napolitano
“Skewed class Distributions and Mislabeled Examples”
- 18:00-- **Closing Remarks**

Dstream - Data Streaming Mining and Management

Room:	Council Bluffs B
Co-chairs:	Wei Fan, Haixun Wang, Philip Yu

- 8:00-- **Registration**
- 8:30-- **Invited Talk by Dimitrios Gunopulos**
- 9:30-- S. Muthukrishnan, Eric van den Berg, and Yihua Wu
“Sequential Change Detection on Data Streams”
- 10:00-- **Coffee Break**
- 10:30-- Alan Ratner, and Ron Loui
“High Speed Identification of Language and Script”
- 11:00-- Morteza Analoui, and Mohammad Hossein Rezvani
“Hierarchical Two-Tier Ensemble Learning: A New Paradigm for Intrusion Detection in Computer networks”
- 11:30-- Budhaditya Saha, Mihai Lazarescu, and Svetha Venkatesh
“Infrequent Item Mining in Multiple Data Streams”
- 12:00-- **Lunch Break**
- 14:00-- Marcel Narnstedt, Kai-Uwe Sattler, Dirk Habich, and Wolfgang Lehner
“Quality of Service-Driven Stream Mining”
- 14:30-- Fatih Altıparmak, David Chiu, and Hakan Ferhatosmanoglu
“Incremental Quantization for Aging Data Streams”
- 15:00-- Wael A Emara, and Mehmed Kantardzic
“Incremental Approach for Semi-Supervised SVM”
- 15:30-- **Coffee Break**
- 16:00-- Jan Peter Patist
“Optimal Window Change Detection”
- 16:30-- Xiangliang Zhang, Michele Sebag and Cecile Germain
“Toward Behavioral Modeling of a Grid System Mining the Logging and Bookkeeping files”

SSTDM - Spatial and Spatio-Temporal Data Mining

Room:	Elkhorn A
Co-chairs:	Chang-Tien Lu, Ashok Samal, Shashi Shekhar

- 8:00-- **Registration**
- 8:30-- **Welcome**
- 8:45-- **Keynote Speech**
- 10:00-- **Coffee Break**
- 10:30-- Wei Ding, Christoph Eick, Xiaojing Yuan, Jing Wang, , and Jean-Philippe Nicot
"On Regional Association Rule Scoping"
- 10:50-- Ranga Raju Vatsavai and Budhendra Bhaduri
"An Hybrid Classification Scheme for Mining Multisource Geospatial Data"
- 11:10-- Elizabeth Wu and Sanjay Chawla
"Spatio-Temporal Analysis of the relationship between South American Precipitation Extremes and the El Nino Southern Oscillation"
- 11:30-- ZongBo Shang and Jeffery Hamerlinck
"Applied Statistics and Spatial Data Mining to Study Land Cover in Wyoming: Can We Predict Vegetation Coverage from Environmental Variables?"
- 11:40-- Ana Cristina Costa and Amilcar Soares
"Space-Time Interpolation and Uncertainty Assessment of an Extreme Precipitation Index Using Geostatistical Cosimulation"
- 11:50-- Florian Verhein and Ghazi Al-Naymat
"Fast Mining of Complex Spatial Co-location Patterns using GLIMIT"
- 12:00-- **Lunch Break**
- 13:30-- Tsegaye Tadesse
"The Vegetation Outlook (VegOut): A New Tool for Providing Outlooks of General Vegetation Conditions Using Data Mining Techniques"
- 13:40-- Vikramaditya Jakkula, Aaron Crandall, and Diane Cook
"Knowledge Discovery in Entity Based Smart Environment Resident Data Using Temporal Relations Based Data Mining"
- 13:50-- Sigal Elnekave, Mark Last, and Oded Maimon
"A Compact Representation of Spatio-Temporal Data"

- 14:00-- Shyamanta M. Hazarika
"Pattern Mining as Abduction: From Snapshots to Spatio-temporal Sequential Patterns"
- 14:20-- **Panel on Spatial-Temporal Patterns in Human Activity Data Sets**
- 15:30-- **Coffee Break**
- 16:00-- Peter Phillips and Ickjai Lee
"Areal Aggregated Crime Reasoning through Density Tracing"
- 16:20-- Leonardo Mariote, Claudia Medeiros, and Ricardo Torres
"Diagnosing similarity of oscillation trends in time series"
- 16:40-- April Kerby, David Marx, Ashok Samal, and Viacheslav Adamchuck
"Spatial Clustering"
- 17:00-- Marc Joliveau and Florian de Vuyst
"Space-time summarization of multisensor time series. Case of missing data."
- 17:20-- Angelica Garcia and Peter Baumann
"Modeling Fundamental Geo-Raster Operations with Array Algebra"
- 17:40-- Falko Schmid
"Formulating, Identifying and Analyzing Individual Spatial Knowledge"
- 18:00-- **Audience Feedback & Closing Remarks**

PPDM - Privacy Aspects of Data Mining

Room:	Elkhorn C
Co-chairs:	Stanley Oliveira, Jaideep Vaidya and Rebecca Wright

8:00--	Registration
8:30--	Keynote Speaker: Dr. Bhavani Thuraisingham (University of Texas at Dallas)
9:20--	Osman Abul, Maurizio Atzori, Francesco Bonchi, and Fosca Giannotti “Hiding Sensitive Trajectory Patterns”
9:40--	Jie Wang, Jun Zhang, Lian Liu, and Dianwei Han “Simultaneous Pattern and Data Hiding in Unsupervised Learning”
10:00--	Coffee Break
10:30--	Aleksandra Slavkovic, Yuval Nardi, and Matthew Tibbits “Secure Logistic Regression of Horizontally and Vertically Partitioned Databases”
10:50--	Artak Amirbekyan and Vladimir Estivill-Castro “Privacy-Preserving k-NN for Small and Large Data Sets”
11:10--	Geetha Jagannathan, Krishnan Pillaipakkamnatt and D. Umano “A Secure Clustering Algorithm for Distributed Data Streams”
11:30--	Geetha Jagannathan and Rebecca N. Wright “Private Inference Control For Aggregate Database Queries”
11:50--	Murat Kantarcioglu and Onur Kardes “Privacy-Preserving Data Mining Applications in the Malicious Model”
12:10--	Lunch Break

ICDM 2007 Workshop Program Committees and Organizations

Workshops and Organizations:

Data Mining in Web 2.0 Environments

Organizer: Andreas Hotho, Michael Wurst and Ravi Kumar
Contact: Andreas Hotho, University of Kassel, hotho@cs.uni-kassel.de
Michael Wurst, University of Dortmund, michael.wurst@uni-dortmund.de
Website: <https://www.kde.cs.uni-kassel.de/ws/Web2DM>
Program Committee: Lada Adamic, University of Michigan
Bettina Berendt, Humboldt-University Berlin
Fabio Ciravegna, University of Sheffield
Martin Ester, Simon Fraser University Vancouver
Ronen Feldman, ClearForest Corp.
Dimitrios Gunopulos, University of California Riverside
Marko Grobelnik, J. Stefan Institute Ljubljana
Siggi Handschuh, DERI Galway
Thomas Hofmann, Google
Hillol Kargupta, UMBC Maryland
Nick Koudas, University of Toronto
Ernestina Menasalvas, Polytechnical University of Madrid
Srujana Merugu, Yahoo!
Dunja Mladenic, J. Stefan Institute Ljubljana
Katharina Morik, University of Dortmund
Srinivasan Parthasarathy, Ohio State University
Maarten van Someren, University of Amsterdam
D. Sivakumar, Google
Gerd Stumme, University of Kassel
Panayiotis Tsaparas, Microsoft

Knowledge Discovery from Multimedia Data and Multimedia Applications

Organizer: Xingquan Zhu, Dacheng Tao and Walid G. Aref
Contact: [Xingquan Zhu](mailto:xqzhu@cse.fau.edu), Florida Atlantic University, xqzhu@cse.fau.edu
[Dacheng Tao](mailto:dtao@polyu.edu.hk), Hongkong Polytechnic University
[Walid G. Aref](mailto:waf@cs.purdue.edu), Purdue University
Website: http://www.cse.fau.edu/~xqzhu/kdm/ICDM07_kdm.html
Program Committee: Shu-Ching Chen, Florida International University, USA
Mohamed G. Elfeky, Google Research, USA
Jiangping Fan, University of North Carolina at Charlotte, USA
Mohand-Said Hacid, Université Claude Bernard Lyon 1, France
Moustafa A. Hammad, University of Calgary, Canada
Ihab F. Ilyas, University of Waterloo, Canada
Xiaodong Lin, University of Cincinnati, USA

Ibrahim Kamel	University of Sharjah, UAE
Eamonn Keogh	University of California - Riverside Riverside, USA
JungHwan Oh	University of North Texas, USA
Jia-Yu (Tim) Pan	Google Inc., USA
Petra Perner	iBai Institute, Germany
Jialie Shen	Singapore Management University, Singapore
Mei-Ling Shyu	University of Miami, USA
Zhongfei (Mark) Zhang	Binghamton University, USA
Dong Zhang	Google Research, China

Mining and Management of Biological Data

Organizer: Wei Wang and Luke Huan

Contact: Wei Wang, University of North Carolina@Chapel Hill
 Luke Huan, University of Kansas

Website: <http://people.eecs.ku.edu/~jhuan/MMBD>

Program	Chris Bailey-Kellogg	Dartmouth college, USA
Committee:	Deepak Bandyopadhyay	Johnson & Johnson, USA
	Christian Blaschke	Bioalma, Spain
	Joseph Bockhorst	University of Wisconsin - Milwaukee, USA
	Xue-wen Chen	University of Kansas, USA
	Francisco Couto	Informatics Department at Faculdade de Ciencias da Universidade de Lisboa, Portugal
	Hasan Jamil	Wayne State University, USA
	Ruoming Jin	Kent State University, USA
	Sun Kim	Indiana University, USA
	Stefan Kramer	Technical University of Munich, Germany
	Vipin Kumar	University of Minnesota, USA
	Jing Li	Case Western Reserve University, USA
	Tao Li	Florida International University, USA
	Hongfang Liu	Georgetown University, USA
	Jinze Liu	University of North Carolina at Chapel Hill, USA
	Jingchu Luo	Peking University, China
	Gerald Henry Lushington	University of Kansas, USA
	Hiroshi Mamitsuka	Kyoto University, Japan
	Dietrich Rebholz-Schuhmann	European Bioinformatics Institute, UK
	Mona Singh	Princeton University, USA
	Peter Smith	University of Kansas, USA
	Min Song	New Jersey Institute of Technology, USA
	Shin-Mu Vincent Tseng	National Cheng Kung University, Taiwan
	Iosif Vaisman	George Mason University, USA
	Jason T. L. Wang	New Jersey Institute of Technology, USA
	Yu-Ping Wang	University of Missouri-Kansas City, USA
	Brook Wu	New Jersey Institute of Technology, USA
	Xintao Wu	University of North Carolina at Charlotte, USA
	Dong Xu	University of Missouri - Columbia, USA
	Jiong Yang	Case Western Reserve University, USA
	Hui Yang	San Francisco State University, USA

Jieping Ye	Arizona State University, USA
Mohammed J. Zaki	Rensselaer Polytechnic Institute, USA
Aidong Zhang	State University of New York at Buffalo, USA
King Zhang	M. D. Anderson Cancer Center, USA
Yanqing Zhang	Georgia State University, USA
Shuigeng Zhou	Fudan University, China

Data Mining in Medicine

Organizer: Daniela Stan Raicu and Mohammad Siadat

Contact: Daniela Stan Raicu, Depaul University, draicu@cs.depaul.edu
 Mohammad Siadat, Henry Ford Health System, siadat@rad.hfh.edu

Website: <http://facweb.cs.depaul.edu/research/vc/DMMed07/>

Program Committee: Sameer Antani, National Library of Medicine, NIH, USA
 David Channin, Northwestern University, USA
 Nicholas DeClaris, University of Maryland, USA
 Thomas Deserno, RWTH Aachen, Germany, USA
 Farshad Fotouhi, Wayne State University, USA
 Jacob Furst, DePaul University, USA
 James Gee, University of Pennsylvania, USA
 Guohua Geng, Northwest University, China
 Larry Hall, University of South Florida, USA
 Jayashree Kalpathy-Cramer, Oregon Health and Science University, USA
 Vasilis Megalooikonomou, Temple University, USA
 Valerie Petrusin, The Nielson Company, USA
 Vili Podgorelec, University of Maribor, Slovenia
 Mohammed Saeed, Philips Medical Systems, USA
 Ishwar Sethi, Oakland University, USA
 Li Shen, University of Massachusetts Dartmouth, USA
 Marius Truta, Northern Kentucky University, USA
 Vincent Tseng, National Cheng Kung University Hospital, Taiwan
 Shusaku Tsumoto, Shimane Medical University, Japan
 Osmar Zaiane, University of Alberta, Canada

Optimization-based Data Mining Techniques with Applications

Organizer: Yong Shi

Contact: Yong Shi (yshi@mail.unomaha.edu)
 College of Information Science and Technology
 University of Nebraska at Omaha NE 68182 USA

Website: <http://dm.ist.unomaha.edu/IEEE-ICDM07-WH-OPT-DM-call-for-papers.htm>

Program Committee: Shingo Aoki, Osaka Prefecture University, Japan
 Wanpracha Art Chaovalitwongse, Rutgers, State University of New Jersey, USA
 Masato Koda, University of Tsukuba, Japan
 Kin Keung Lai, City University of Hong Kong, Hong Kong, China
 Heeseok Lee, Korea Advanced Institute Science and Technology, Korea

David Olson, University of Nebraska at Lincoln, USA
Jiming Peng, University of Illinois at Urbana-Champaign, USA
John Wang, Montclair State University, USA
Shouyang Wang, Chinese Academy of Sciences, China
Xiaobo Yang, Daresbury Laboratory, Warrington, UK
Ning Zhong, Maebashi Institute of Technology, Japan

High Performance Data Mining

Organizer: Alok Choudhary, Ying Liu
Contact: Alok Choudhary, choudhar@ece.northwestern.edu,
Ying Liu, lzlliu@yahoo.com
Website: http://www.ece.northwestern.edu/~yingliu/ICDM2007_HPDMining.html
Program Committee: Jayaprakash Pisharath, Intel Corporation, USA
Wei-keng Liao, Northwestern University, USA
Zhiling Lan, Illinois Institute of Technology, USA
Xingquan Zhu, Florida Atlantic University, USA
Yingjie Tian, Research Center on Data Technology and Knowledge Economy of Chinese Academy of Sciences
Steve Chiu, Idaho State University, USA
Joseph Zambreno, Iowa State University, USA
Jun Xu, Microsoft Research Asia
Ying Zhao, Tsinghua University, China
Jing He, Research Center on Data Technology and Knowledge Economy of Chinese Academy of Sciences
Cheng Wang, Agilent Technologies

Mining Graphs and Complex Structures

Organizer: Xifeng Yan, Lawrence B. Holder
Contact: Xifeng Yan, IBM T.J. Watson Research Center, xifengyan@us.ibm.com
Lawrence B. Holder, Washington State University, holder@wsu.edu
Website: <http://www.xifengyan.net/MGCS2007/>
Program Committee: Jiawei Han, University of Illinois, USA
Yan Liu, IBM, T. J. Watson Research Center, USA
Thomas Gaertner, Fraunhofer Inst. for Autonomous Intelli. Systems, Germany
Michael R. Berthold, University of Konstanz, Germany
Takashi Washio, Osaka University, Japan
Frank Olken, LLNL and National Science Foundation, USA,
Istvan Jonyer, Oklahoma State University, USA
Ehud Gudes, Ben-Gurion University of the Negev, Israel
Lise Getoor, University of Maryland, USA
Tina Eliassi-Rad, Lawrence Livermore National Laboratory, USA
Karsten M. Borgwardt, University of Munich
Joost N. Kok, Leiden University, Netherlands
Siegfried Nijssen, Katholieke Universiteit Leuven, Belgium

Thorsten Meinl, University of Konstanz, Germany
Yun Chi, NEC Research Labs, USA
Jason T-L Wang, New Jersey's Science and Technology University, USA
Mohammed J. Zaki, Rensselaer Polytechnic Institute, USA
Christos Faloutsos, Carnegie Mellon University, USA

Data Mining on Uncertain Data

Organizer: Jiong Yang, Reynold Cheng
Contact: Jiong Yang, jjong@eecs.case.edu,
Reynold Cheng, csckcheng@comp.polyu.edu.hk
Website: <http://www4.comp.polyu.edu.hk/~dmu07/>
Program Committee: Michael Chau, Univ. of Hong Kong
Lei Chen, Hong Kong Univ. of Science and Technology
Mehmet M. Dalkilic, Indiana University
Nilesh Dalvi, University of Washington
Mohamed G. Elfeky, Google Inc.
Ada Fu, Chinese Univ. of Hong Kong
Robert Gwadera, Helsinki Univ. of Technology
Edward Hung, Hong Kong Polytechnic Univ.
Dmitri V. Kalashnikov, University of California, Irvine
Murat Kantarcioglu, UT Dallas
Sun Kim, Indiana Univ.
Carson K. Leung, Univ. of Manitoba
Nikos Mamoulis, Univ. of Hong Kong
Jennifer Neville, Purdue Univ.
Sunil Prabhakar, Purdue Univ.
Yufei Tao, Chinese Univ. of Hong Kong
Jaideep Vaidya, Rutgers Univ.
Kevin Yip, Yale Univ.
Man Lung Yiu, Aalborg Univ.
Donghui Zhang, Northeastern Univ.

Data Streaming Mining and Management

Organizer: Wei Fan, Haixun Wang, Philip Yu
Contact: Wei Fan, Haixun Wang, Philip Yu
Website: <http://magna.cs.ucla.edu/~hxwang/dsmm07/index.html>
Program Committee: Arkady Zaslavsky, Monash University, Australia
Bianca Zadrozny, Fluminense Federal University (UFF), Brazil
Gary Weiss, Fordham University
Joao Gama, University of Porto, Portugal
Jianyong Wang, Tsinghua University, China
Jeffery Xu Yu, Chinese University Hongkong, China
Le Gruenwald, University of Okalohoma
Kun Zhang, Xavier University

Mehmed Kantardzic, University of Louisville
Shenghuo Zhu, NEC Lab America,
Vijay Raghaven, University of Louisiana
Ying Yang, Monash University, Australia

Spatial and Spatio-Temporal Data Mining

Organizer: Chang-Tien Lu, Ashok Samal, Shashi Shekhar
Contact: Chang-Tien Lu, ctlu@vt.edu,
Ashok Samal, samal@cse.unl.edu,
Shashi Shekhar, shekhar@cs.umn.edu
Website: <http://spatial.nvc.cs.vt.edu/sstdm07/>
Program Committee: Gennady Andrienko Fraunhofer Institute IAIS, Germany
Vania Bogorny Hasselt University, Belgium
Reynold Cheng Hong Kong Polytechnic University, Hong Kong
Max Egenhofer University of Maine, USA
Christoph Eick University of Houston, USA
Vladimir Estivill-Castro Griffith University, Australia
Shashi Gadia Iowa State University, USA
Diansheng Guo University of South Carolina, USA
Yan Huang University of Northern Texas, USA
Bart Kuijpers Hasselt University, Belgium
Nikos Mamoulis University of Hong Kong, Hong Kong
David Marx University of Nebraska, Lincoln, USA
Michael May Fraunhofer AIS, Germany
Mirco Nanni KDD Laboratory ISTI-CNR Pisa, Italy
Dimitris Papadias Hong Kong University of Science and Technology, Hong Kong
Dieter Pfoser Computer Technology Institute, Greece
Cyrus Shahabi University of Southern California, USA
Chi-Ren Shyu University of Missouri-Columbia, USA
Yannis Theodoridis University of Piraeus, Greece
Ranga Raju Vatsavai Oak Ridge National Laboratory, USA
Hui Xiong Rutgers University, USA
Jin Soung Yoo University of Minnesota, USA
May Yuan University of Oklahoma, USA
Donghui Zhang Northeastern University, USA
Xiaofang Zhou University of Queensland, Australia

Privacy Aspects of Data Mining

Organizer: Stanley Oliveira, Jaideep Vaidya and Rebecca Wright
Contact: Stanley Oliveira, Jaideep Vaidya and Rebecca Wright
Website: <http://cimic.rutgers.edu/~padm>
Program Committee: Justin Brickell, University of Texas at Austin, USA
Barbara Carminati, University of Insubria, Italy
Ping Chen, University of Houston-Downtown, USA

Ricardo Dahab, State University of Campinas, Brazil
Vladimir Estivill-Castro, Griffith University, Australia
Csilla Farkas, University of South Carolina, USA
Hilol Kargupta, University of Maryland Baltimore County, USA
Helger Lipmaa, University College, London, UK
Wagner Meira Junior, Federal University of Minas Gerais, Brazil
Taneli Mielikäinen, Nokia Research Center, Palo Alto, USA
Kobbi Nissim, Ben-Gurion University, Israel
Benny Pinkas, University of Haifa, Israel
Yücel Saygin, Sabanci University, Turkey
Aleksandra B. Slavkovic, Penn State University, USA
Adam Smith, Penn State University, USA
Vassilis Verykios, University of Thessaly, Greece
Danfeng Yao, Brown University, USA
Justin Zhan, Carnegie Mellon University, USA